

NISCH Dörr + vägg / NICHE Door + wall

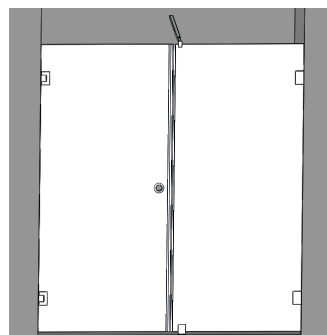

Vänster / Left

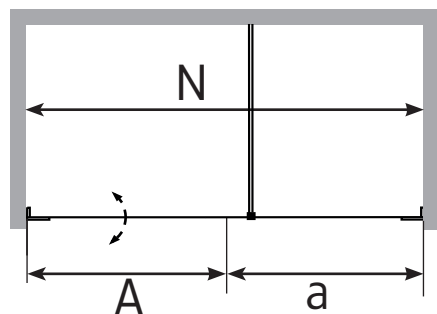
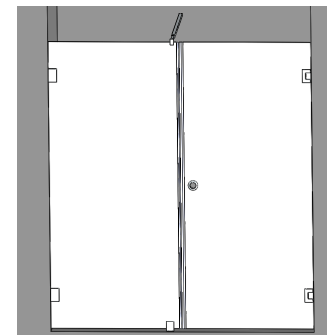

Höger / Right

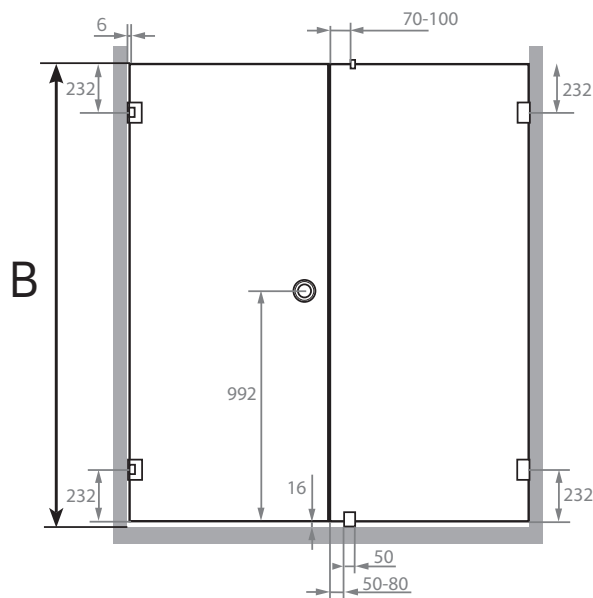

Mått / Measurements

- N**
- A** 600-1000 mm (dörr / door)
- a** 600-1000 mm (vägg / wall)
- B** 1000-2000 mm

Dörrens placering / Location of the door

- Vänster / Left
- Höger / Right

Beslag / Fittings

- Krom / Chrome
- Svart / Black
- Mässing / Brass

Glas / Glass

- Klarglas / Clear
- Kristall / Cristal
- Gråtonat / Tinted grey
- Bronstonat / Tinted bronze
- Linjeglas / Fluted glass

Tillvalskapning / Additional cuts

Fyll i på sid 2 / Fill in on page 2

- Snedkapning / Skew cut
- Urtag för rör / sockel / Cut for pipe or shelf

| | | |
|-----------------------------------|--|------------------------------------|
| Description INFINITY modell 21 | Specialbeställning. Kan ej avbeställas eller returneras. Custom made order. Can not be cancelled or returned. | |
| Project | Revision of drawing and date (Hafa) | Approved by Hafa signatur and date |
| Retailer | Retailer signature | Hafa order nr |
| Customer | Customers signature | |

NISCH Dörr + vägg / NICHE Door + wall

Snedkapning (endast för fast vägg)
Slanted cuts (only for fixed walls)

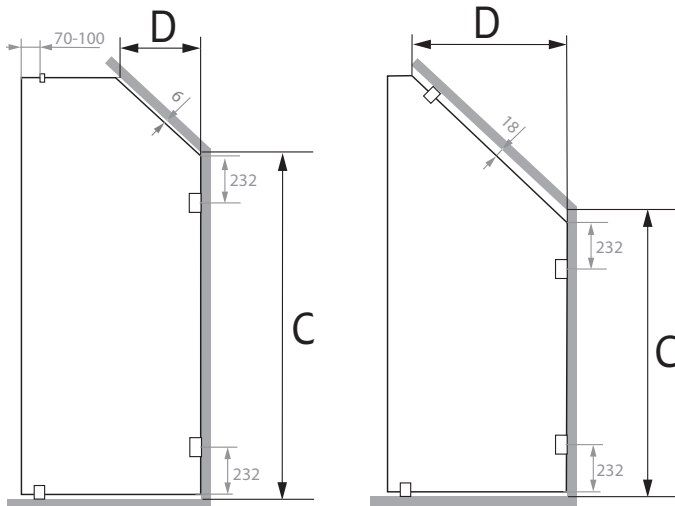

Med fixeringsstag
With fixationbar

Med takfäste
With ceiling fixation

Urtag för rör
Cut for piping

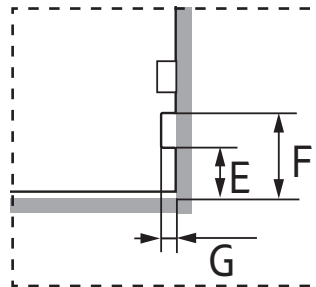

Urtag för sockel
Cut for shelf

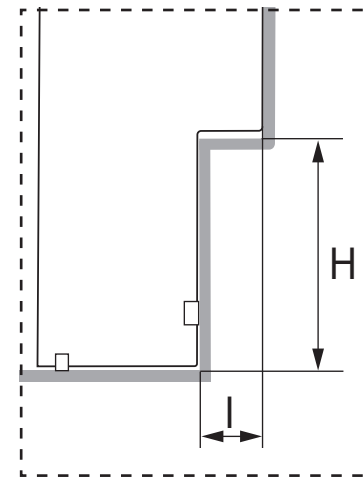

Mått / Measurements

C

D

Med fixeringsstag / With fixationbar

Med takfäste / With ceiling fixation

Urtag för rör / Cut for piping

E 50-200 mm

F 50-200 mm

G 20-100

Urtag för sockel / Cut for shelf

H 300-1500 mm

I 50-600 mm

| | | | |
|--|-----------------------------------|--|------------------------------------|
| | Description INFINITY modell 21 | Specialbeställning. Kan ej avbeställas eller returneras. Custom made order. Can not be cancelled or returned. | |
| | Project | Revision of drawing and date (Hafa) | Approved by Hafa signatur and date |
| | Retailer | Retailer signature | Hafa order nr |
| | Customer | Customers signature | |